



Parks & Recreation Advisory Board Meeting

Friday, March 6th, 2026 – 7:00am
651 10th Avenue, Room 101C

Meeting ID: 231 882 100 940 91

Passcode: nS2t39tE

[Download Teams](#) | [Join the Meeting Now](#)

Or call in (audio only)

[+1 970-671-5831](#), [861031426#](#) United States, Collbran

[Find a local number](#)

[Phone conference ID: 861 031 426#](#)

Agenda

- 1. Call to Order**
- 2. Roll Call**
- 3. Agenda Approval**
- 4. Approval of Minutes**
- 5. Citizen Input**
- 6. Board Member Committee Reports: Art Commission – Sharon Wright**
- 7. Susan Murray - Parks under Development Update**
- 8. Staff Reports**
- 9. Arroyos Trail Naming and New Natural Area Naming**
- 10. Old Business - NA**
- 11. New Business – Select Chair and Vice Chair**
- 12. Scheduling of Meetings – Tentatively Friday, April 3rd, 2026, at Rodarte Center**
- 13. Adjournment**

**Our Mission: Provide services, experiences, and spaces that promote
community, health, and wellbeing for all.**

The Parks & Recreation Advisory Board meets the first Friday of the month at 7:00 am. For information on how to place an item on the agenda, email: Jema.Moody@Greeleygov.com at least one week prior to the scheduled meeting date.

GREELEY PARKS AND RECREATION ADVISORY BOARD
MEETING MINUTES – February 6th, 2026.

1. ROLL CALL

The Greeley Parks and Recreation Advisory Board met Friday, February 6th, 2026, at 7:00am at the Greeley Recreation Center. Board members joining: Greg McIntosh, Rand Morgan, Kirsten Daniel, Beth Kleiber, Sharon Wright, Eric Parrish, Ben Christiansen, and Savanna Bennett. City Council Liaison Deb DeBoutez.

Staff joining: Diana Frick (Director of Culture Parks and Recreation), Benjamin Alexander (Business Manager), Eric Bloomer (Parks Division Manager), Kaitlyn Ikenouye (Natural Areas & Trails and Trails Interim Crew Supervisor), Becca Mack (Recreation Manager), Jema Moody (Interim Office Manager).

2. APPROVAL OF AGENDA – Eric Parrish made a motion to approve the agenda, which was seconded by Ben Christianson, and passed unanimously.

3. APPROVAL OF MINUTES – Beth Kleiber made a motion to approve the minutes of the previous meeting, which was seconded by Sharon Wright and passed unanimously.

4. CITIZEN INPUT – None

5. BOARD MEMBER COMMITTEE REPORTS – Art commission – Sharon Wright – Centennial Village the Depot is the new entrance Salmas Store is being reimaged, create a makers space and start an artist in residents. Presentation to City Council for realignment of the Boards, an overall Arts and Culture Board. Tointon Gallery Art Reception – Brush with Nature.

Diana – Discussed the proposal and purpose of combining the boards to one Arts and Culture Board. With City Council approval, they will be looking at how they will select the board members and still have a liaison for Parks and Recreation Advisory Board. Still a lot to do before City Council meeting in April, new application process and bylaws.

6. STAFF REPORTS-

Parks – Eric Bloomer - There have been requests to open restrooms, sports will begin by the end of the month with soccer and flag football. Removal of playgrounds at Coyote Run and Pheasant Run, adding signage with QR codes to get community input for what they would like to see. Demolition took 10 days. Planning division is working on putting together the input and then will come up with designs. 4 playgrounds to replace this year Twin Rivers, Brentwood, Peak view and Pheasant Run. Partner with nearby schools to get input. Grandparents requesting shaded seating.

Natural Areas – Kaitlyn Ikenouye – Trail counter data shows some areas are up and some are down. With the weather being so nice there are a lot more trail use. Volunteer opportunities, partnership with Volunteers for Outdoor Colorado (VOC) – owl monitoring, trail maintenance, identify pollinator species, and remove nonnative species ie Russian Olive trees. Review of social media stats.

Recreation- Becca Mack – Anniversary Planning 3 facilities celebrating 20 years – Ice Hau, Discovery Bay, and Family Funplex. Friday June 19th through Sunday June 21st with conjunction of the Family Field Day. Historical boards of each facility. Passport of fun and turn in for recreation swag. ‘20 years of play.’

Discovery Bay – Play on the way. Recreation as a division will have a presence in the 4th of July parade. Active Adult Center visits over 100,000 per year with 900 active memberships.

7. **Goals for upcoming year 2026** – Find things that encourage you as a board member.
 1. **Community Awareness** – Champion major projects – Social media presence.
 2. **Equity, Access and Participation** – Promote scholarships and access programs and Encourage awareness of bilingual or culturally relevant programming.
 3. **Becoming strong CPRD Ambassadors** – Regular site visits to see real conditions and opportunities.
 4. **Strategic Projects and Council Priorities** – Track progress on Island Grove Master Plan or Lincoln Park and Understand the current budget environment and structural challenges.
 5. **Board Effectiveness and Engagement** – Improve communication flow and agenda structure, increase board presence at CPRD events or project milestones, and Strengthen subcommittees or working groups.
Quarterly longer meeting (budget and planning). Susan Murray - Capital Projects and Planning.
3 Site visits during the year. Summer and Fall. Arroyos, Delta Park, Kiwanis. 30-minute Tour of the facilities. Back up facility would be the Recreation Center. Develop a Mater Calendar based on the City Master Plan.

8. **OLD BUSINESS – NA**

9. **NEW BUSINESS** – Meeting dates changed as follows - July 3rd meeting moved to July 10th and September 4th to September 11th.

10. **UPCOMING AGENDAS** – April Meeting to be at the Rodarte Center.

11. **NEXT MEETING** – The next meeting is tentatively scheduled for March 6th, 2026.

12. **ADJOURNMENT** – Sharon Wright called for a motion to adjourn the meeting, was seconded by Beth Kleiber at 7:58 am.

Respectfully submitted:

Greg McIntosh, Chair

Diana Frick, Director of Culture, Parks and Recreation

Recreation Updates

Greeley Active Adult Center

The Active Adult Center had a successful Open House on Feb 10th. Estimated attendance is 175 community members. Successfully sold new memberships, gave tours, collected participant information through BINGO and shared programming opportunities. Staff and AAC volunteers ensured this event was a success, through their hard work and engagement.

International/travel trips are very popular, estimated about 20 or more have signed up for each, the Cape Code and Ireland 2026 trips. Planning is already underway for expansion of international/travel trips in 2027.

Construction on a new wall and glass doors are favored by the community and staff for appearance and sound mitigation.

We are looking forward to our St. Patrick's Day Lunch on March 17th with Adult Irish Folk Dancers who will perform in addition to lunch.

Construction on the front desk remodel began on Friday February 27, with removal of cabinets and shelves. Installation of new cabinets starts Monday March 2, 2026, followed by additional construction for 3-4 weeks until completion of the remodel.





Rodarte Community Center

The Rodarte Rising Mentorship Program, funded through a NRPA grant, is kicking off in March, with 8 mentors selected and paired with afterschool care participants.

SPAIR

Youth Sports Spring Leagues:

- Soccer: 820 enrolled, 81 waitlisted
- Flag Football: 433 enrolled, 31 waitlisted
- Tennis: 91
- Spring sports clinics: 42

**Waitlists due to no more coaches being registered, or people with specific preferences for teams that are full.*

Adult Sports Spring Leagues

- 134 teams registered



RECREATION 2025 KPI ROADMAP

"LET'S WALK TOGETHER TO SEE OUR COMMUNITY IMPACT"



RECREATION FACILITIES

950,000 + people visited our Recreation facilities, with the Family Fun Plex seeing the most annual visitors.

SWIM LESSONS

We taught over 2,000 kids and adults to swim in 2025, which keeps kids safe in the water and strengthens their skills and confidence.

FITNESS

Over 22,000 people committed to moving their bodies by participating in our variety of Group Exercise classes.

ICE HAUS

At the Greeley Ice Haus, over 1,000 children and adults learned to skate, fueling a passion and strengthening a skill.

ACTIVE ADULT CENTER

In 2025, over 3,000 active older adults enriched their lives through group trips, arts and crafts, club activities, sports and fitness, education programs, and entertainment programs.

SPORTS

Over 10,000 adult and youth engaged in a sports activity, learning a new skill, teamwork, social engagement, and increased physical activity.

CHILDCARE

We supported children in our afterschool program and summer day camp at the Rodarte Community Center and Anna Gimmestad Community Center.

RECREATION

In 2025, over 165,000 youth and adults enrolled in various Recreation activities.



Temporary Trail Routes / Rutas de Senderos Temporarios

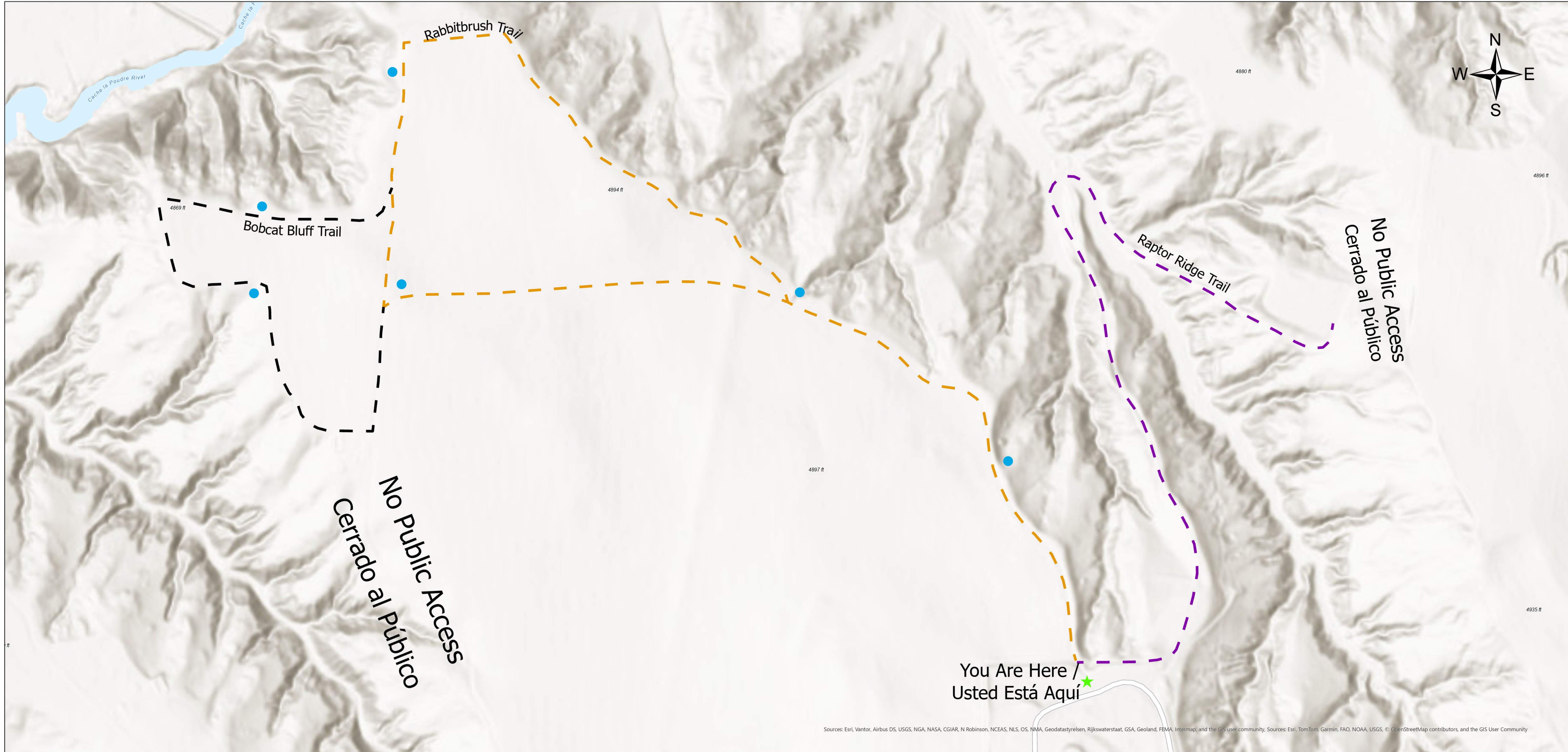

Sources: Esri, Vantor, Airbus DS, USGS, NGA, NASA, CGIAR, N Robinson, NCEAS, NLS, OS, NMA, Geodatasyreisen, Rijkswaterstaat, GSA, Geoland, FEMA, Intermap, and the GIS user community. Sources: Esri, TomTom, Garmin, FAO, NOAA, USGS, © OpenStreetMap contributors, and the GIS User Community

Legend / Leyenda

- ★ Trailhead / Inicio del Sendero
- Raptor Ridge Trail
- Rabbitbrush Trail
- Bobcat Bluff Trail
- Bench / Banco

Temporary Trail Routes / Rutas de Senderos Temporarios

Name	Distance	Difficulty
Raptor Ridge Trail	1.68 miles round trip (millas ida y vuelta)	Difficult / Difícil
Rabbitbrush Trail	1.82 miles round trip (millas ida y vuelta)	Easy / Fácil
Bobcat Bluff Trail	0.65 miles (millas)	Moderate / Moderada

Culture, Parks & Recreation Department Facility and Property Naming Policy

Adopted 03.04.22

by Parks & Recreation Advisory Board

PURPOSE

The Culture, Parks, and Recreation Department (CPRD) acquires lands, and constructs facilities and other amenities as part of the normal operation and growth of the department. Many of the facilities and properties are named through a community engagement process. This policy will detail the process and standards from which the City will solicit community input, provide recommendations, and secure approval for naming of applicable CPRD facilities.

SCOPE

This policy is applicable to all existing and future CPRD managed properties, facilities, and other amenities that have been/will be named.

This policy is not intended to supersede or place restrictions on naming of facilities through sponsorships or similar underwriting of events, facilities, or amenities within CPRD. The process and standards for sponsorship naming rights are provided through the Guidelines for Naming Rights, adopted by City Council in 2003 (Appendix A).

SITE NAMING

As new properties and facilities are acquired and developed, they need to be named, or an existing site may need to be renamed for a variety of reasons. The Greeley Municipal Code (section 2-422) currently provides that the Parks & Recreation advisory board submit name recommendations for City parks to City Council for approval and adoption by Resolution. The naming process is set out below.

Greeley municipal code section (section 2-805) currently provides similar guidance for the Island Grove Park Advisory Board, using the naming process set out below, except that City Council's approval not required.

While specific code guidance isn't detailed for the Museum, Rodarte Center, and other advisory boards, this policy, and its associated process and guidelines, should direct the naming process for those boards as well.

NAMING PROCESS

The City, through staff and the above-referenced advisory boards, shall use the following process to name or rename CPRD properties and facilities.

- A. Newly Acquired/Constructed Property or Facility
 - 1) The applicable advisory board or commission, by way of CPRD staff, will solicit suggestions from the public to name the property/facility. Additional effort should be made to garner feedback from groups that do not typically engage in public processes, and nearby populations that require specific engagement efforts.

- 2) Staff will provide a report to the advisory board or commission that summarizes the background of the property based on Division standards and management goals. Staff will also compile and provide the full list of submitted name suggestions to the Board within the report, along with a short list of recommended names that all meet the criteria in subsection C below.
- 3) The advisory board or commission shall review the suggested names and select one name to recommend to City Council.
- 4) The City Council shall affirm the name of the property/facility by resolution.

B. Name Changes to Existing Properties/Facilities

In some cases, a need may arise to change the name of a property or facility. When the applicable advisory board or commission or CPRD staff identifies the need to change the name of an existing property or facility, staff will present options and a recommendation to the Board for consideration. If the Board concurs with the recommendation to change a name, the process detailed in subsection A above will be followed.

C. Naming Criteria

The applicable advisory board or commission will select a name for a property or facility that meets one or more of the following criteria:

- The name of a culturally relevant and/or historical event, structure or artifact that occurred or was found on the property or in the vicinity
- The name of an individual or family name linked to the history of the property or facility, with the following guidelines:
 - the name should have local significance
 - displayed outstanding, long-term commitment and made significant contributions to the betterment of the community;
 - made noteworthy contribution to the development and improvement of culture, parks and recreation, conservation, or outdoor recreation activities;
 - prominent in the history of the development of Greeley;
 - historic landowner and/or the homesteading family of the property
 - name of person/family that has contributed significant funds for the specific park, natural area or trail, or for parks and recreation in general.
 - the immediate former landowner's name may be used if the property was donated or significantly discounted when conveyed to the City (typically greater than 50% of overall cost/value of the project)
- A natural landmark, feature or habitat type in the vicinity of the natural area or trail section
- The name of a native wildlife or plant species that occupies the property or vicinity, and/or has occupied the vicinity in the past
- A person or family that has contributed significantly to the applicable division's mission and management goals over a long period of time in the Greeley community

Other Considerations:

Acquisition of new parcels and construction of new trail sections contiguous to existing properties or trail sections, respectively, should use the same name as the original natural area or trail section unless significant circumstances dictate another name should be chosen, compliant with

the criteria set forth in this policy. An exception to this guideline will be stand-alone and/or trail spur sections that connect to larger regional trail sections that may necessitate a different name to aid in wayfinding.

D. Exclusions

The following guidelines provide direction of names for CPRD properties and facilities that should be avoided:

- a current City employee (former employees' names may be considered)
- a current local elected official
- a person, family, organization, business, or other affiliation with an overt political, controversial, or otherwise divisive nature
- a name that is similar to an existing facility, road, trail, property, etc. that may cause confusion for the public.

In addition to the exclusions above, the following guidelines provide direction for names that should be avoided for a natural area or trail:

- The name of non-native or invasive wildlife or vegetation species
- Any names of the subdivision, development, or developer of an adjacent property, even if the natural area or trail section was conveyed and/or constructed as a part of the development agreement, unless the name meets the criteria in Section C above.

Communications & Engagement Natural Area Naming Engagement Campaign

Summary of community engagement

Purpose

Engage residents in selecting an official name for the 42-acre natural area while increasing awareness of its recreational value and stormwater function.

Engagement Strategy

The campaign combined digital engagement, on-site visibility, and educational storytelling to drive participation and awareness.

Tactics

- Speak Up Greeley page serving as the central information hub
- Interactive Ideas Board allowing residents to submit name suggestions with explanations
- Coordinated organic social media campaign promoting participation and deadline reminders
- Educational content highlighting site features, including a post on red-winged blackbirds and a repurposed University of Northern Colorado wildlife video
- On-site yard signs and door hangers directing trail users and nearby residents to the naming opportunity

Results

- 35 name submissions received through the Ideas Board
- 436,635 total social media reach during the campaign period

Impact

The campaign elevated the visibility of a previously unnamed natural area, increased community awareness of its location provided residents with a meaningful opportunity to shape the identity of a public space.

Name Suggestion	Explanation	Name of person	meet naming criteria? (Y/N)	Staff Comments	Notes
Whispering Reeds Natural Area		Aimee, freeland42@hotmail.com	Y	Reeds are not a dominant plant species at these locations. Cattails are a more dominant plant species.	
Owl Ridge Natural Area	This space is practically the backyard for the Owl Ridge and Mountain Vista neighborhoods so it seems appropriate to call it Owl Ridge. Despite being really close to the MV neighborhood, this space doesn't scream "vista" to me but still has a beautiful view of the mountains.	AB, amylambbahar@gmail.com	Y	Not appropriate for all properties included, since it spans more than one subdivision, Naming Policy avoids subdivision names.	
Owl Ridge Nature Trail		LDM, ldm4jc@gmail.com	Y	Not appropriate for all properties included, since it spans more than one subdivision.	
Centennial Trail		LR, lnrichardson@comcast.net	Y	Not specific to this area or property, no location connection to Michener.	
Roaming Turkey Natural Area		Omar Munoz, omunoz0223@gmail.com	Y	Not many turkeys on this property.	
Owl Cove		JJA, jjadesigner@gmail.com	Y	Property is not a cove.	
Owl Marsh		Owl Marsh, qsbblue@gmail.com	Y	Marsh is more of a seaside topography.	
Hoot In Hollow Park	My daughter and I came up with this name as a way to honor the majestic owls, other wildlife, and Mother Nature at this park. Perhaps the owls will serve as a gateway for encouraging conservation conversations to be had for generations to come. Discussions that can't be taught in a book or behind a computer screen, but rather an inner peace that is felt on the inside when visiting the park. What a "hoot in hollow" day that will be!	LMcKee, countrycam@gmail.com	Y	Suggest change to "Hooting Hollow"	
The roost	From my wife!	Sean, spedigo14@gmail.com	Y	Suggest adding a bird species to the name, such as "Raptor or Red-Wing Roost."	
Maple Treeway		Peyton Black, peytonblack38@gmail.com	Y	No maple trees on this property	
The Wild Connection	Encompasses all the wild animals, vegetation, and the connection of people, trails, and water shed.	TB, tbarger845@aol.com	Y	Would be more appropriate for a more programmed space, like nature play.	
Owl Ridge	Owl Ridge would be a great name! 🦉 🦉	Dylan, dgaub25@gmail.com	Y	Not appropriate for all properties included, since it spans more than one subdivision.	
Triple Creek Draw	Three creeks all with draws.	gregpuzzles1, glchristian@comcast.net	Y	The creek provides the geologic connection between all the parcels. May consider removing the word "draw" to shorten and simplify the name.	

SOARING HAWK		Mah, markhoutchens@yahoo.com	Y		
Ute Camp or Ute Vista Natural Area (submitted on behalf of Larry Rogstad)	A section of the booklet relating back to Carl and Emil Tunnell, who came to the Hazelton Community by covered wagon in 1905, relates to the 'Indian affairs which had taken place previously on the prairie southwest of the present school (which was located at the SE corner of 71st Ave and 10th St). It is fascinating in its description of Sheep Creek at that time and use of the creek and associated draw (Valley) by the Utes. It talks of Indian built dams on the Creek, and occupation periodically by the Utes while hunting buffalo, making war on other Indian bands etc. The women gathered the crystal clear water, war dances were held, trout were gathered by hand....., but that terrain was reshaped by a flood in 1935 which erased much of the improvements that Utes had made to the land. The narrative also speaks to Utes using the bluffs and high hills along Sheep Draw and nearby Cache la Poudre as lookout points, to observe bison movements and keep watch for marauding bands of enemies (Cheyenne and Arapahoe) that at times competed for this territory, eventually displacing the Utes permanently to their final mountain land. No doubt, just like us, there were times when Utes probably looked out admiringly at the natural beauty that this vista provides still today. The suggested name UTE CAMP honors the utilization of the Sheep Draw as part of the high plains buffalo commons essential to plains Indian tribes prior to historic settlement. UTE VISTA (my favorite name) provides a somewhat prosaic description of those who used this land before us, gazing the distant hills and prairie that was their home. My favorite part of this trail is the vista from near the detention pond where one can gaze to the MTS, distant Pierce escarpment and the far Laramie Plains.	AmyB, Amy.Bahar@greeleygov.com	Y	Consulted with City of Greeley Museum staff on indigenous names	First, with the Ute camp name, while it's certainly true that the Ute used the Poudre and its resources, apart from the Shawshen story we couldn't find any evidence for a Ute camp in the area. That doesn't mean there wasn't one, just that the information provided can't be corroborated with the information we have. I also wonder if the information in the Hazelton booklet took on a hint of factoids. By 1905, native interactions along the Poudre were a distant memory, unless they learned the information first-hand from living Ute people - which is entirely possible. There may have been, and likely was, uses of the land there by natives, but was it by Ute bands or another tribe? Also, the story of the dams in the creek ring somewhat true, but it's just as possible without evidence that this was done by the Anglo-European settlers - maybe by early colonists.
Hazelton Heights Natural Area (submitted on behalf of Larry Rogstad)	This natural area is located in the center of the old Hazelton District which stretched from Evans west to approximately HWY 257. At founding, areas as they settled were named for local schools established by and built by settlers through donation of land, building materials and sweat equity. The center of this community is the Hazelton School which has had six iterations since first founded. The fifth Hazelton School, a two room school with teacherage, was erected at the intersection of 10th Street and 71st Ave (where King Soopers is located) in 1909, with the MCMIX label prominently displayed on the plaque on the bell tower. Seeing MCMIX, many people thought that was the school's name so it was colloquially called McMIX. When the 10th and 71st intersection was slated to be improved in the early 1990's, the schoolhouse was slated for destruction. As in previous iterations, a community project took on the work of preserving and moving the Hazelton School to its 6th location, the Poudre Learning Center, two miles to the north, where it continues to educate children and remains a community hub. There are many offspring and heirs to original settlers of the Hazelton community, including Claudia Sitzman who serves as a link to Hazelton settlers.	AmyB, Amy.Bahar@greeleygov.com	Y	Possible confusion with Hazelton Park which is nearby.	
Arapahoe Winter Camp Natural Area (submitted on behalf of Larry Rogstad)	I remember having read in another book, the name of which I can't recall, that the Spiritual Chief Niwot's band of Arapaho favored the Sheep Draw area in vicinity of current 20th Street and 71st Ave as a periodic winter camp because of the clear clean water, and abundant wildlife (food) that wintered in vicinity. While Niwot is well known and his name represented in multiple locations along the Northern Front Range, the Arapahoe tribe, along with the Cheyenne were the predominant tribes on the pre-settlement high plains of Northern Colorado and Southern Wyoming, once they had pushed the Ute to the mountains to the west. They were the noted horseman of the bison common from which Greeley was carved, and deserve honoring through naming this area they once valued.	AmyB, Amy.Bahar@greeleygov.com	Y	Consulted with City of Greeley Museum staff on indigenous names	Attributing the area to the Arapaho is a little clearer, but again there's no firm evidence to support this in the area. I don't doubt for a second that Niwot's band, or other Arapaho bands, camped in the winter along the Poudre throughout the 19th century. We have historical and oral evidence for this. The trouble is that, again, there's no firm proof of it here other than accounts in a book which may or may not be accurate.
Owl Ridge Wetlands		AmyB, Amy.Bahar@greeleygov.com	Y	Not appropriate for all properties included, since it spans more than one subdivision.	

Sagebrush Hollow at Owl Ridge		KK, kristinpace@hotmail.com	Y	Unsure if there is much sagebrush on the property. Hollow is "small sheltered valley, basin, or low lying depression" which does fit well with this topography. Staff suggest Blackbird Hollow or Redwing Hollow to recognize a dominant bird species in the area, the Red-Winged Blackbird.	
Shiloh Bear Natural Area	My Shiloh Bear passed away last June and this is the area we walked in everyday for 14 years. He always loved exploring and would love to honor him. We live in owl ridge and now I walk my other Newfoundlands everyday here.	KK, kristinpace@hotmail.com	Y	Pet names, while not forbidden by the naming policy, are not recommended since they will not have meaning for people other than the person making the suggestion.	
✦ Golden Crest Path ✦		DianaV, dvieyra0348@gmail.com	Y	"crest" doesn't fit well with this topography.	
Raleigh's Bend	Named after our late Raleigh dog who passed unexpectedly last May. She always loved walking this trail every day and saying hi to other dogs and rabbits.	GB, gbuko91@gmail.com	Y	Pet names, while not forbidden by the naming policy, are not recommended since they will not have meaning for people other than the person making the suggestion.	
Déjà vu	Déjà vu - we walk the trail regularly, even more during COVID, and our family refers to it as Déjà vu!	PKW, weiserfam@gmail.com	Y		
Cottontail Trail (since owls eagles and hawks feed in the area)		TBM, tbariemoser@aol.com	Y	Not sure how many rabbits are in the area.	
Shone Nook		JJA, jjadesigner@gmail.com	Y		
Carlotta LaNier	This would be one way Greeley could honor a Colorado resident who changed the world.	Crimson Red, crimson_1995@hotmail.com	N	Does not meet naming criteria because she doesn't have connection to the property.	Carlotta LaNier is one of the "Little Rock Nine" who were the first black students to attend Little Rock Central High School when it was desegregated. She was born in Little Rock, AR. She graduated from UNC and has lived in CO for decades. She has been part of the Colorado Aids Project, Jack and Jill of America, the Urban League and the NAACP. It's unclear whether she has any current or past connections to Greeley and/or in this area of the city, other than attending UNC.
Eleanor Grove		Mike Lehman, mike.lehman@greeleygov.com	N	Does not meet naming criteria because she doesn't have connection to the property.	

Ethel trail	I choose the name because it is after my great grandmother that migrated to Greeley	Jerry, jeremiahgaucin37@gmail.com	N	Does not meet naming criteria because she doesn't have connection to the property.	
Slaughterback Natural Area	Named for Kate Slaughterback, or Rattlesnake Kate. A famous Greeley figure from our history	Brian Hammond, brian.hammond13@me.com	N	Does not meet naming criteria because she doesn't have connection to the property.	While Rattlesnake Kate is a historical figure, she has no connection to this property, and she did not make noteworthy contributions to conservation.
Slaughterback Nook		JJA, jjadesigner@gmail.com	N	Does not meet naming criteria because she doesn't have connection to the property.	While Rattlesnake Kate is a historical figure, she has no connection to this property, and she did not make noteworthy contributions to conservation.
Hawk-Tua Ridge		Tyrone S, sisnerostyrone@hotmail.com	N		
Shoshine (shawsheen) natural area	Shoshine (Shawsheen) a native american women who protected nathan meekers wife and daughter after they were taken captive. There should be more female native american representation. "Shawsheen, along with her husband, adamantly advocated for the release of the captives and their safety. Josephine Meeker said of her captivity, "We all owe our lives to shawsheen" citation-Silbernagel, Robert (2011). Troubled trails : the Meeker affair and the expulsion of the Utes from Colorado. University of Utah Press	Jordan, matajordan13@gmail.com	N	Consulted with City of Greeley Museum staff on indigenous names	Shawsheen was held captive by the Arapaho at Island Grove in Greeley, but the incident with Meeker's wife and daughter took place near Meeker, CO. https://www.visitgreeley.com/blog/post/greeley-stories-remembering-shawsheen/ The only historical association Shawsheen has with the area is at Island Grove - and even this is tinged by long memories, sketchy historical documents and third hand information. Her story is amazing, and her connection with Greeley and the Meekers somewhat clear, but you should be cautious about associating her with a part of the landscape where she may or may not have been even in commemoration.
I would name it Kortokrax Landing	Kortokrax is an old family name. I believe it to be a bit mysterious and full of life just like that area is. It would be an honor to have this name selected but some of the other suggestions are also quite interesting too!	Kortokrax , nooh1974@yahoo.com	N	Does not meet naming criteria because family doesn't connection to the property.	
Stormwater Drainage "Natural" Area	My home abuts the the southeast portion of the "natural" area, where the city recently removed every living plant and tree in order to make improvements to the drainage facilities installed there. The city is more concerned with drainage than maintaining any natural aspects of the space, so let's just call it what it is: an Stormwater Drainage "Natural" Area. The quotes around "Natural" are essential.	Earl Wright, boon.rivers_5o@icloud.com	N		
Slaughterback natural area		AJ, atjoseph33@gmail.com	N	Does not meet naming criteria because she doesn't have connection to the property.	While Rattlesnake Kate is a historical figure, she has no connection to this property, and she did not make noteworthy contributions to conservation.

Parks & Recreation Advisory Board - Agenda Summary

March 6, 2026

Title:

Naming of Natural Area in Owl Ridge/Mountain Vista Neighborhoods

Background:

Seven interconnected parcels, totaling 42 acres in the Mountain Vista and Owl Ridge neighborhoods in west Greeley, comprise the natural area in this naming campaign. The natural area features paved trails, wetlands, grasslands, and stormwater drainage. Runoff from these lands drain into Sheep Draw to the north and the trails connect to the Sheep Draw Trail, with expanded trail connections planned in the future to a new City community Park to the south.

While NAT has been managing this area for several years and has constructed trails and a trailhead on portions of the property, the final parcel had not been conveyed to the City until 2025 when the developer satisfied federal wetland mitigation restoration requirements. Now that all the parcels are under City ownership, and to foster community ownership and raise awareness of this small natural area, NAT staff solicited naming suggestions from the community from January 8 through February 16, 2026 to formally name the natural area. Following the guidelines in the 2022 Culture, Parks, and Recreation Department naming policy (Attachment 1), staff have prepared this agenda item summary to provide background information about the property, assess suggested names from the community, and make recommendations for site names that would be in-line with criteria set forth in the policy.

PROPERTY BACKGROUND

The seven parcels included in this natural area are located between 71st Ave and 82nd Ave east to west and spanning both the north and south sides of 20th St., see the attached map (Attachment 2). The five parcels south of 20th St were conveyed to the City of Greeley by Creek View Investments, LLC between 2015 and 2025. The trail south of 20th St was constructed between 2005 and 2016. The two parcels north of 20th St were deeded to the City of Greeley by Mountain Vista Ventures, LLC for

stormwater detention and non-irrigated open space when the subdivision was developed, between 2000 and 2007. Until about 2017-18, there was an active oil and gas well pad on the land north of 20th St. The trail north of 20th St was constructed between 2019 and 2021. The trail north of 20th St continues north through private property until it connects to the Sheep Draw Trail. The Sheep Draw Trail, in turn, links to the Poudre Trail, offering opportunities for longer regional bike rides and extended outdoor adventures. To the west, the Sheep Draw Trail is planned to cross 83rd Ave in the coming years and to the south, a connection is planned to the westward expansion of the Highway 34 Trail.

SIGNIFICANT NATURAL FEATURES

The natural area is connected via a drainage that flows south to north, into Sheep Draw. North of 20th St, two drainages merge before reaching Sheep Draw, earning this area the nickname "Triple Creek." This natural area is also a working part of Greeley's stormwater infrastructure. The wetlands and drainage channels manage runoff during storms, capturing water before it can flood streets and properties downstream. These natural systems offer multiple benefits: they slow rushing water during heavy rains, filter pollutants naturally, recharge groundwater and provide habitat for birds, amphibians, and other wildlife. The wetlands created by stormwater ponds provide habitat for notable native species such as Red-winged blackbirds, and hawks can often be seen soaring overhead. Nestled in a residential subdivision, this natural area provides close-to-home nature experiences and expanding trail connections.

NAMING SUGGESTIONS

NAT staff worked closely with the City's Communication and Engagement (C&E) department to promote a naming campaign for this natural area, from January 8 through February 16, 2026. C&E has provided a summary of this community outreach (Attachment 3). There were a total of 35 names suggested (Attachment 4). Staff have reviewed the names and assessed each based on the criteria detailed in the CPRD Naming Policy. Ten names were removed for not meeting the naming policy criteria, leaving 25 name suggestions for the property.

Staff Recommendations

The following property names encompass both meeting the criteria set forth in the CPRD naming policy, while also having a strong relation to the location, natural history, and culture of the site and surrounding area. Staff recommend the Board consider one of the following names for the property:

Red-wing Roost or Raptor Roost Natural Area

"The Roost" was suggested as a name by the community. Staff suggest adding a bird species to the name to give it more grounding in the local ecosystem. Red-winged blackbirds are commonly sighted in the area in the natural area's wetlands, and their

distinctive song permeates the experience as users enjoy the trail. Several raptor species also frequent the area.

Triple Creek Draw Natural Area or Triple Creek Natural Area

The name suggestion identifies the confluence of the drainages from this natural with Sheep Draw. The creek is the landscape feature that ties these seven parcels together into one cohesive natural area. The name was submitted as “Triple Creek Draw” but the Board may also consider shortening the name to “Triple Creek”.

Soaring Hawk Natural Area

As previously noted, hawks are frequently seen soaring above this area. This name highlights one of the many species this natural area supports.

Hooting Hollow Natural Area or Blackbird Hollow Natural Area

More than one name suggestion included the word “hollow.” A hollow is a “small sheltered valley, basin, or low lying depression” – a description that fits this natural area well. Staff suggest adjusting the language slightly to recognize some of the species commonly seen in this natural area. “Hooting Hollow” recognizes the owls that are present, and which give Owl Ridge its name. “Blackbird Hollow” recognizes the Red-winged blackbird, a notable resident of this natural area.

Decision Options:

- The Board may recommend one of the staff-recommended property names to City Council for final adoption.
- The Board may recommend one of the other names on the full list of suggestions that meet the CPRD naming policy criteria.
- The Board may reject all names and ask staff to solicit additional names based on the process laid out in the NAT naming policy.

Suggested motion(s)

- I move to recommend permanently naming the seven natural area parcels within the Owl Ridge and Mountain Vista neighborhoods to _____ (name), and to forward the recommendation to Greeley City Council to adopt the name by Resolution.

Attachments:

- 1) CPRD Naming Policy
- 2) Map
- 3) C&E Public Engagement Summary
- 4) Name Submissions